



TILE SCOPE



BACKSPLASH TILE:

AZ TILE
~60SF

Calacatta UMBER Honed 3 x 12

Direction/Orientation: Horizontal

Pattern: 1/3 Offset

Grout: 1/8" joint (#640 Arctic White)

MITER TILE AT WINDOW

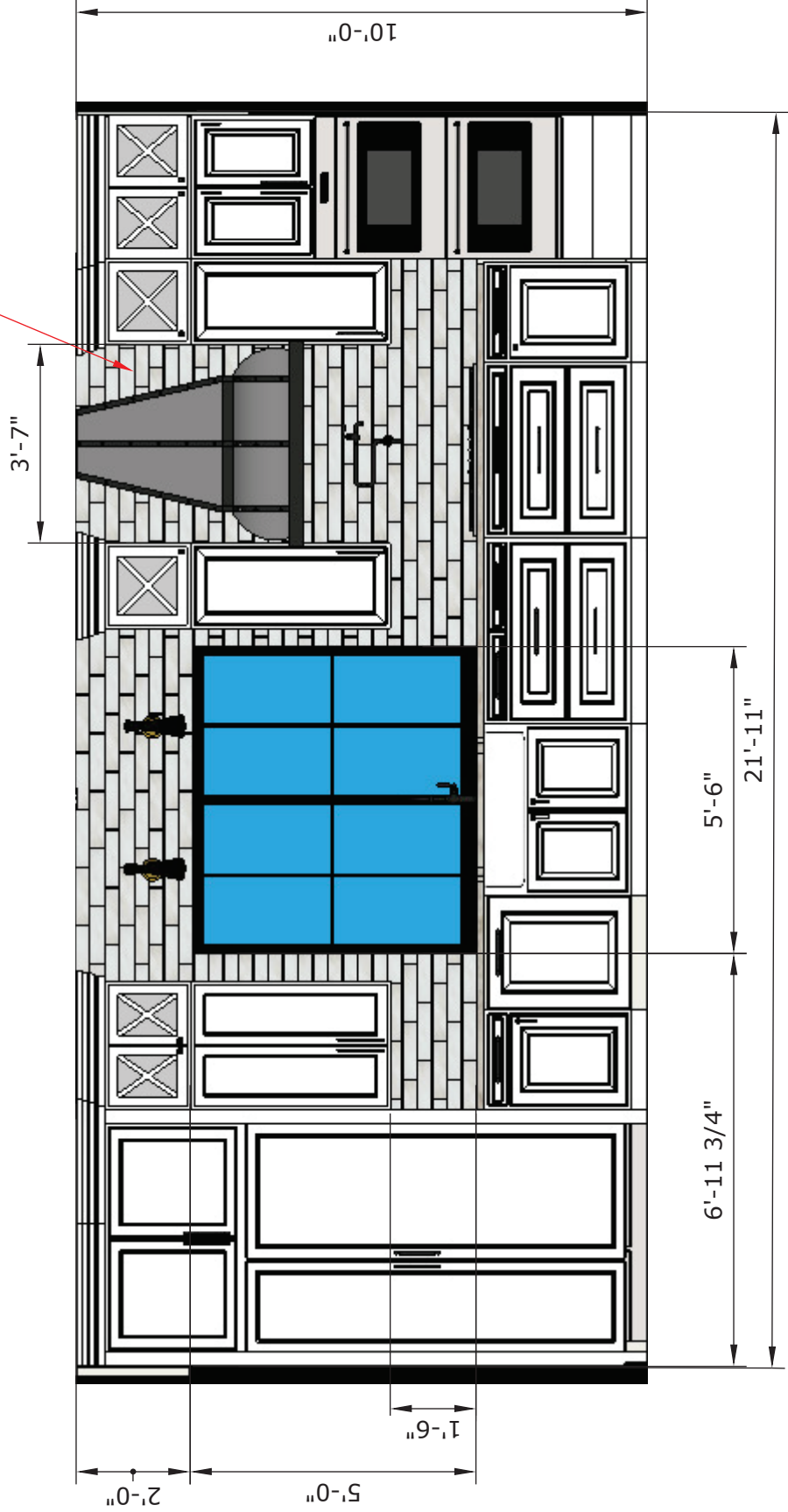

ISSUE
3/3/2023

RE-ISSUE
MM.DD.YY

DESCRIPTION
KITCHEN

KITCHEN ELEVATION

A

K1.1

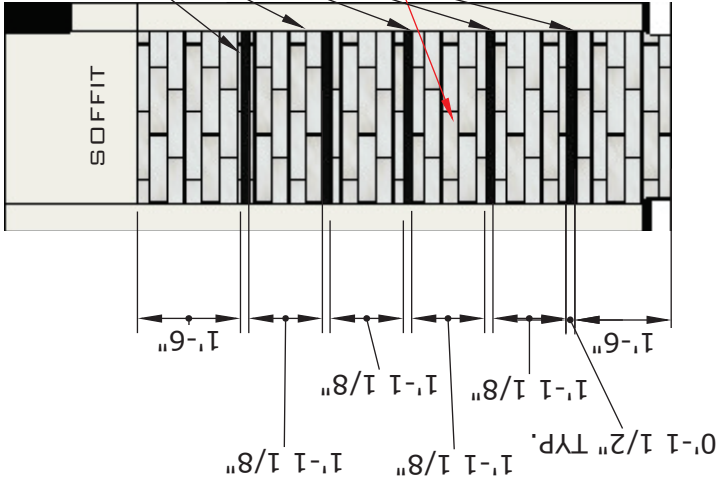

Floating Shelf Typ.

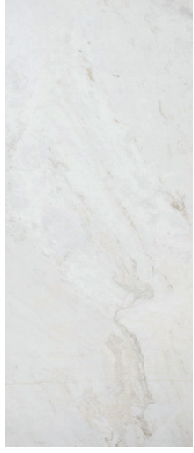

BACKSPLASH TILE:

AZ TILE
 ~24SF
 CALACATTA UMBER HONED 3 X 12
 DIRECTION/ORIENTATION: HORIZONTAL
 PATTERN: 1/3 OFFSET
 GROUT: 1/8" JOINT (#640 ARCTIC WHITE)

B KITCHEN ELEVATION

ISSUE
 3/3/2023

RE-ISSUE
 MM.DD.YY

DESCRIPTION
 KITCHEN

K 1.2

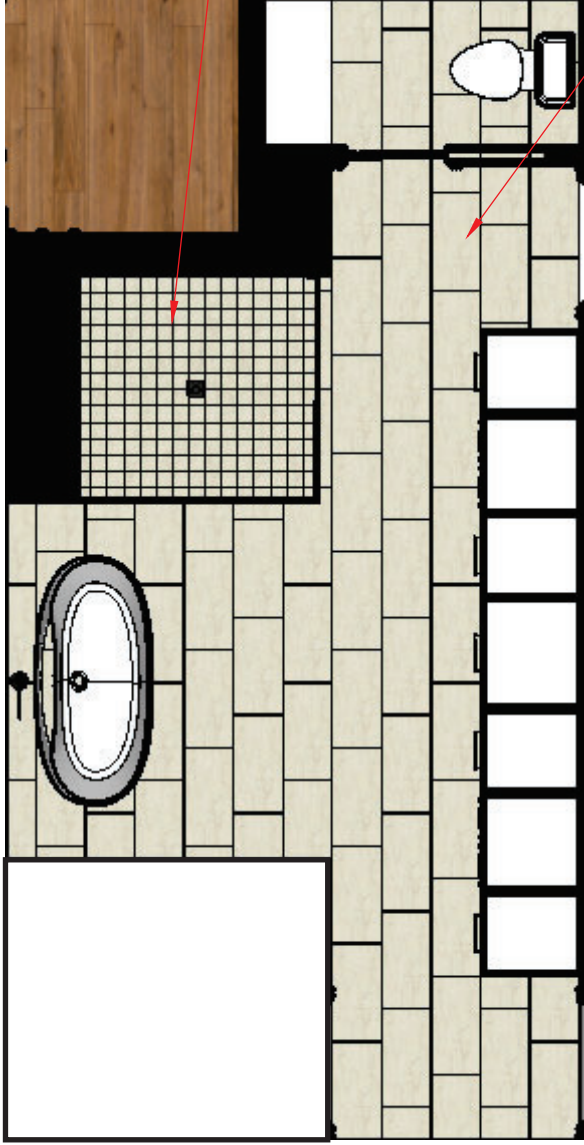

SHOWER FLOOR TILE:

FACINGS OF AMERICA
~255F

ATLAS CONCORDE 2X2
MOSAIC PORCELAIN

MARVEL CREMO DELICATO
DIRECTION/ORIENTATION: HORIZONTAL

PATTERN: MOSAIC

GROUT: 1/8" JOINT (#11 SNOW WHITE)

DEPRESSED SLAB(CURBLESS)



FLOOR TILE:

FACINGS OF AMERICA
~1605F

ATLAS CONCORDE 12 X 24
PORCELAIN

MARVEL CREMO DELICATO

DIRECTION/ORIENTATION: HORIZONTAL

PATTERN: 1/3 OFFSET

GROUT: 1/8" JOINT (#11 SNOW WHITE)

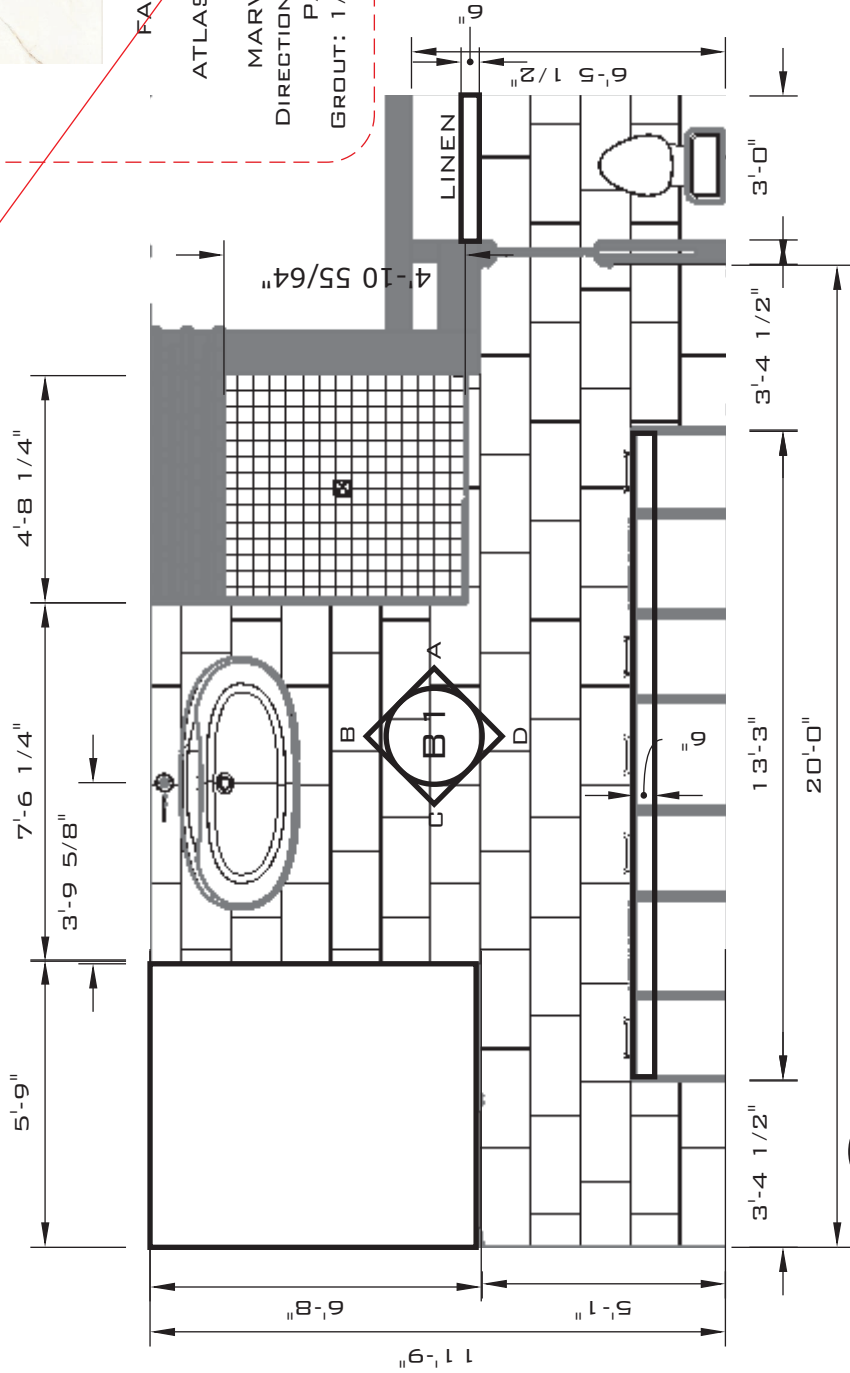
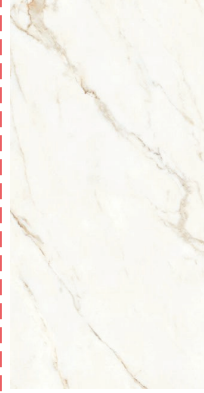

RE-ISSUE
MM.DD.YY

DESCRIPTION
PRIMARY
BATHROOM

B1 1.3

1 PRIMARY ENSUITE FLOOR PLAN



MOSAIC TILE:

ANTHOLOGY
~16SF

CHIC TUSCAN ARABESQUE 12X12
DIRECTION/ORIENTATION: MOSAIC
PATTERN: MOSAIC
GROUT: 1/8" JOINT (#381 BRIGHT WHITE)



PENCIL TRIM TILE:

BEDROSIANS
~29 PIECES
PENCIL TRIM
1/2" x 8"

DIRECTION/ORIENTATION: HORIZONTAL
PATTERN: N/A
GROUT: 1/8" JOINT (#11 SNOW WHITE)



WALL TILE:

BEDROSIANS
~52SF

CELINE 2 1/2" x 12"
GLOSSY WHITE

DIRECTION/ORIENTATION: HORIZONTAL
PATTERN: 1/3 OFFSET
GROUT: 1/8" JOINT (#11 SNOW WHITE)

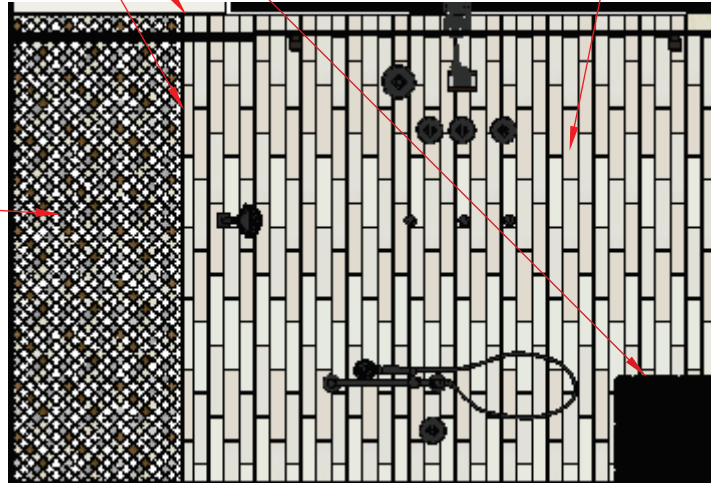

6'-8"

2'-3 1/2"
0'-1/2"

7'-8"

1'-6"
1'-2"

5'-2"

ISSUE
3/3/2023

RE-ISSUE
MM.DD.YY

DESCRIPTION
PRIMARY
BATHROOM

PRIMARY ENSUITE ELEVATION

A

B1 1.4



MOSAIC TILE:
ANTHOLOGY
~37SF

CHIC TUSCAN ARABESQUE 12X12
DIRECTION/ORIENTATION: MOSAIC
PATTERN: MOSAIC
GROUT: 1/8" JOINT (#381 BRIGHT WHITE)



WALL TILE:
BEDROSANS
~101SF

CELINE 2 1/2" x 12"
GLOSSY WHITE
DIRECTION/ORIENTATION: HORIZONTAL
PATTERN: 1/3 OFFSET
GROUT: 1/8" JOINT (#381 BRIGHT WHITE)



PENCIL TRIM TILE:
BEDROSANS
~59 PIECES
PENCIL TRIM
1/2" x 8"

DIRECTION/ORIENTATION: HORIZONTAL
PATTERN: N/A
GROUT: 1/8" JOINT (#11 SNOW WHITE)

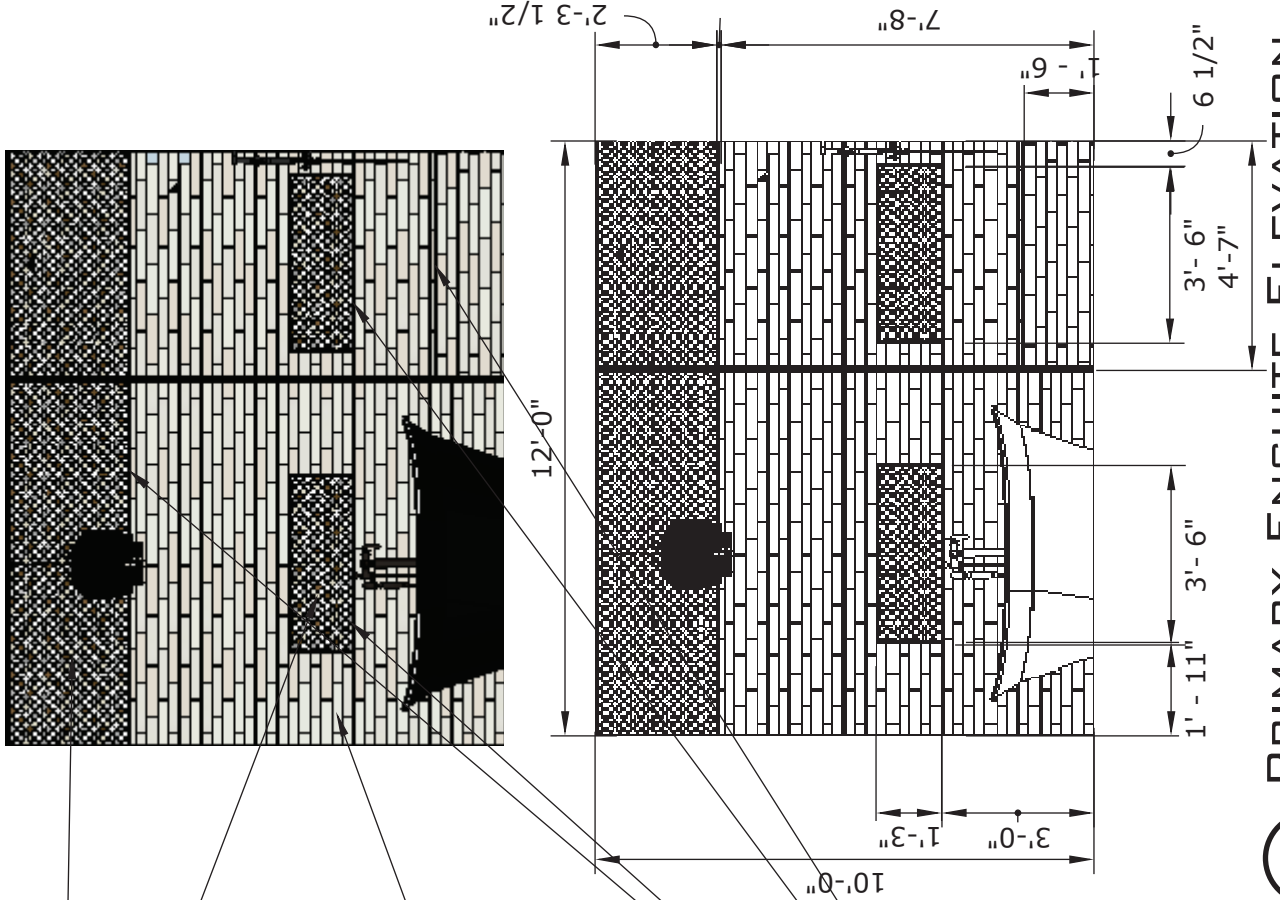

ISSUE
3/3/2023

RE-ISSUE
MM.DD.YY

DESCRIPTION
PRIMARY
BATHROOM

B11.5

B PRIMARY ENSUITE ELEVATION



MOSAIC TILE:
ANTHOLOGY
~18SF

CHIC TUSCAN ARABESQUE 12X12
DIRECTION/ORIENTATION: MOSAIC
PATTERN: MOSAIC
GROUT: 1/8" JOINT (#381 BRIGHT WHITE)



PENCIL TRIM TILE:
BEDROSIANS
~26 PIECES
PENCIL TRIM
1/2" X 8"

DIRECTION/ORIENTATION: HORIZONTAL
PATTERN: N/A
GROUT: 1/8" JOINT (#11 SNOW WHITE)



WALL TILE:
BEDROSIANS
~50SF

CELINE 2 1/2" X 12"
GLOSSY WHITE
DIRECTION/ORIENTATION: HORIZONTAL
PATTERN: 1/3 OFFSET
GROUT: 1/8" JOINT (#11 SNOW WHITE)

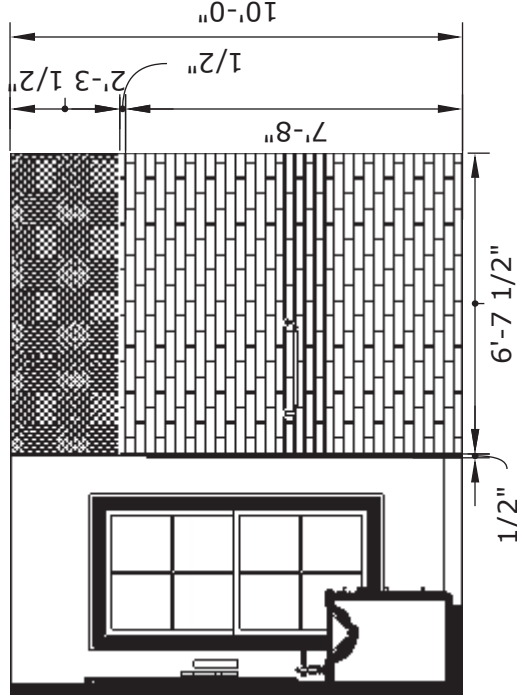
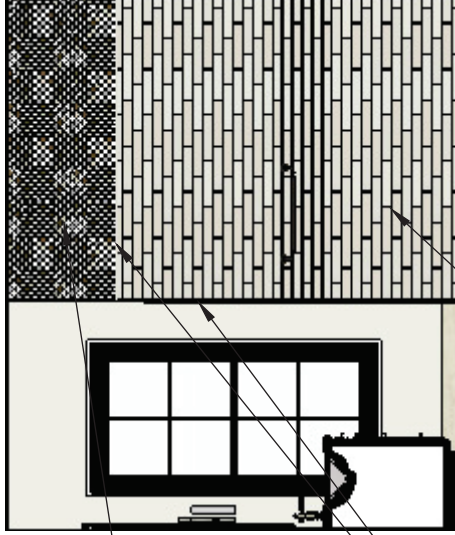

C PRIMARY ENSUITE ELEVATION



ISSUE
3/3/2023

RE-ISSUE
MM.DD.YY

DESCRIPTION
PRIMARY
BATHROOM



MOSAIC TILE:

AZ TILE
~75 SF

GALACATTA UMBER SCALA MESH
DIRECTION/ORIENTATION: VERTICAL

PATTERN: MOSAIC

GROUT: 1/8" JOINT (#640 ARCTIC WHITE)

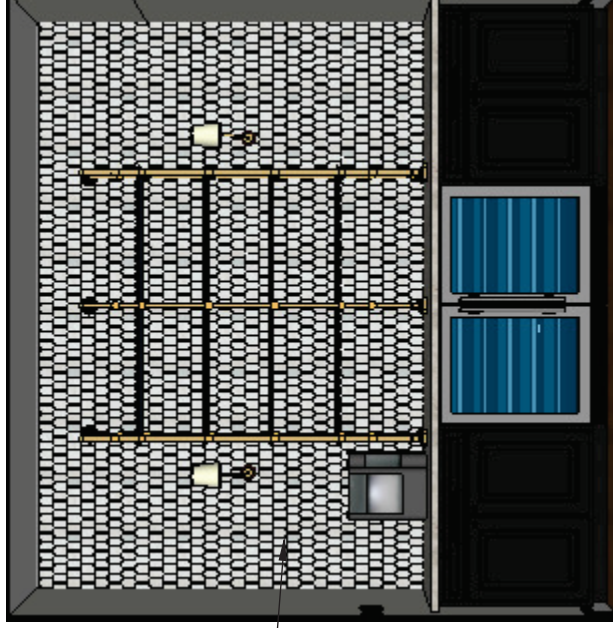

10'-7 1/2"

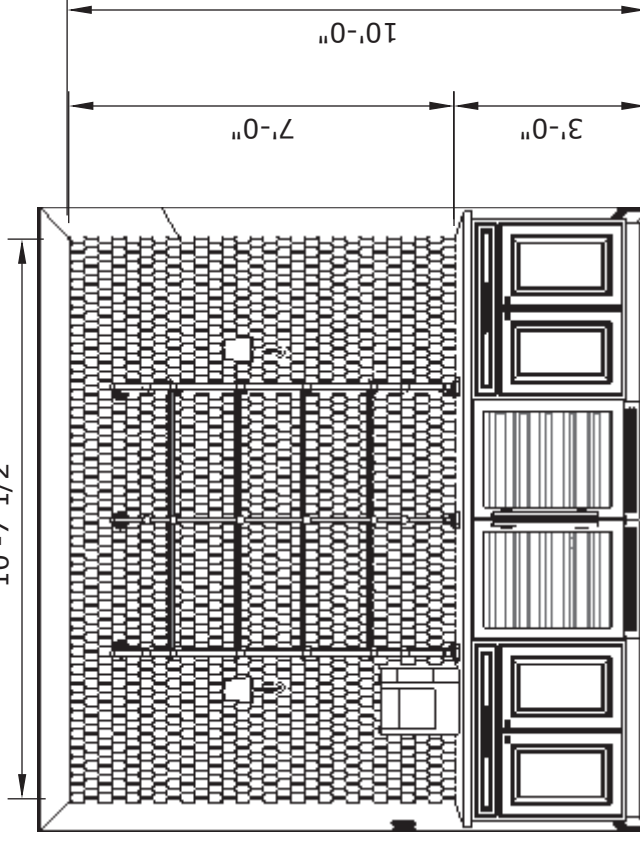

10'-0"

7'-0"

RE-ISSUE
MM.DD.YY

DESCRIPTION
PRIMARY
BATHROOM

BAR ELEVATION



B1 1.7



FLOOR TILE:
 FAGINGS OF AMERICA
 ~82 SF
 EMIL CERAMICA ARABESCATI CORCHINGA
 NATURAL 12 X 24
 DIRECTION/ORIENTATION: HORIZONTAL
 PATTERN: 1/3 OFFSET
 GROUT: 1/8" JOINT (#640 ARCTIC WHITE)



SHOWER FLOOR TILE:
 JC CH 18 ROTUNDA
 COMPOSITION NERO MARQUINA
 ~15 SF
 EMIL CERAMICA ARABESCATI CORCHINGA
 1 X 1
 DIRECTION/ORIENTATION: N/A
 PATTERN: ON MESH
 GROUT: TBD

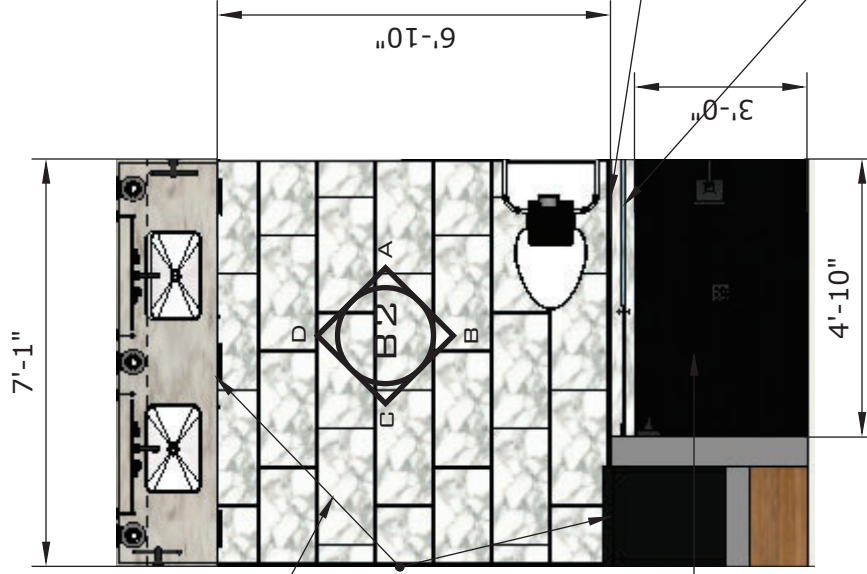

*BOTH SIDES OF CURB
 TO BE TRIMMED WITH
 SCHLUTER JOLLY IN
 BRIGHT WHITE
 QTY: 2

RE-ISSUE
 MM.DD.YY

DESCRIPTION
 PRIMARY
 BATHROOM

*FACE CURB WITH
 FLOOR TILE

1 BATHROOM 2 FLOOR PLAN

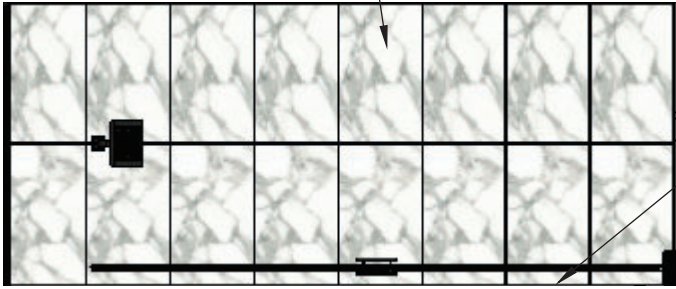

WALL TILE:
 • FACINGS OF AMERICA
 ~28 SF
 EMIL CERAMICA ARABESCATI GORCHINGA
 NATURAL 12 X 24
 DIRECTION/ORIENTATION: HORIZONTAL
 PATTERN: 1/3 OFFSET
 GROUT: 1/8" JOINT (#640 ARCTIC WHITE)



* SCHLUTER JOLLY IN BRIGHT WHITE
 QTY: 1

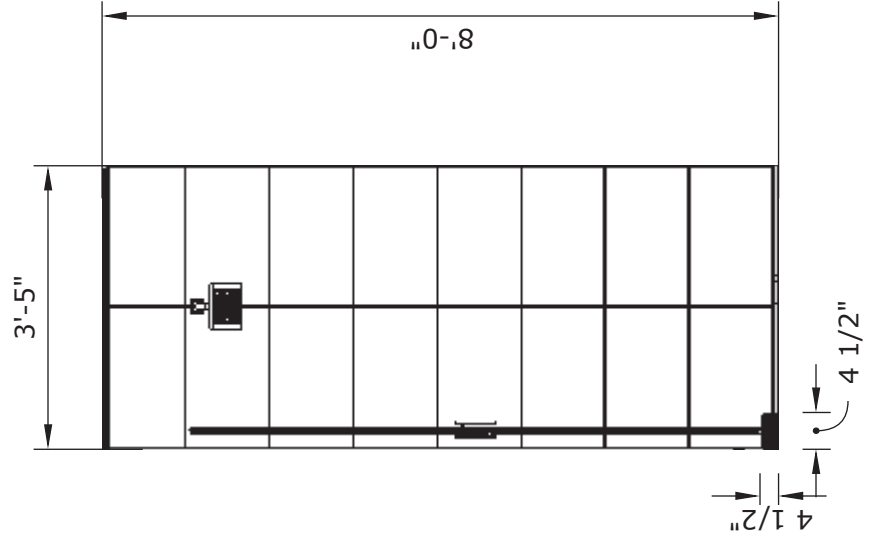

ISSUE
 3/3/2023

RE-ISSUE
 MM.DD.YY

DESCRIPTION
 PRIMARY
 BATHROOM

A BATHROOM 2 ELEVATION

B2 1.9

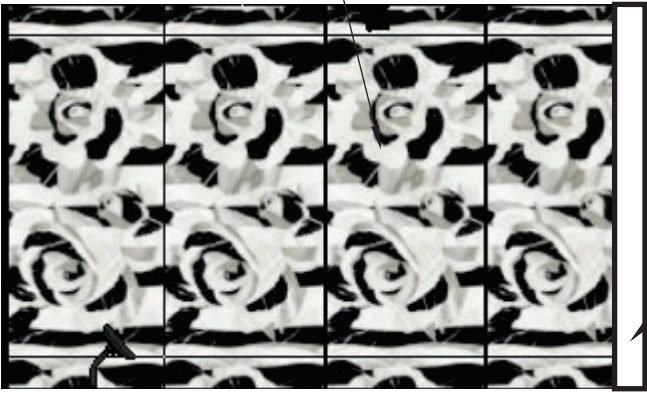

WALL TILE:

FACINGS OF AMERICA
~40SF

TELE DI MARMO TILE MATTE
24 X 48

DIRECTION/ORIENTATION: HORIZONTAL

PATTERN: 1/3 OFFSET

GROUT: 1/8" JOINT (#640 ARCTIC WHITE)

*CENTER ON WALL L/R



WALL TILE:

FACINGS OF AMERICA
~4 SF

EMIL CERAMICA ARABESCATI CORCHINGA
NATURAL 12 X 24

DIRECTION/ORIENTATION: HORIZONTAL

PATTERN: 1/3 OFFSET

GROUT: 1/8" JOINT (#640 ARCTIC WHITE)

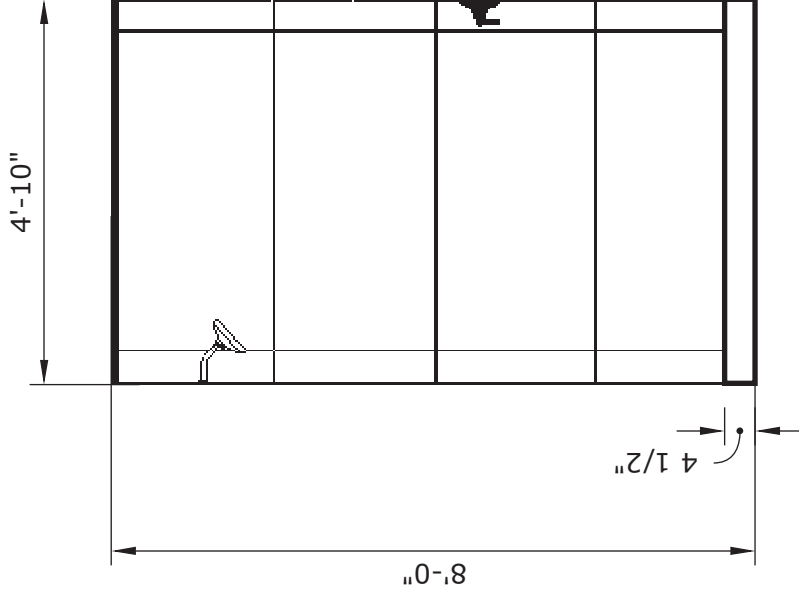

RE-ISSUE
MM.DD.YY

DESCRIPTION
PRIMARY
BATHROOM

B BATHROOM 2 ELEVATION

B2

1.10

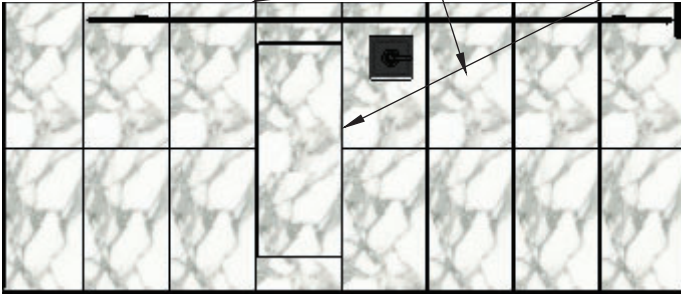

WALL TILE:

- FACINGS OF AMERICA
~30 SF
- EMIL CERAMICA ARABESCATI GORCHINCA
NATURAL 12 X 24
- DIRECTION/ORIENTATION: HORIZONTAL
- PATTERN: 1/3 OFFSET
- GROUT: 1/8" JOINT (#640 ARCTIC WHITE)

*TRIM OPEN END/NICHE
WITH SCHLUTER JOLLY
IN BRIGHT WHITE
QTY: 2

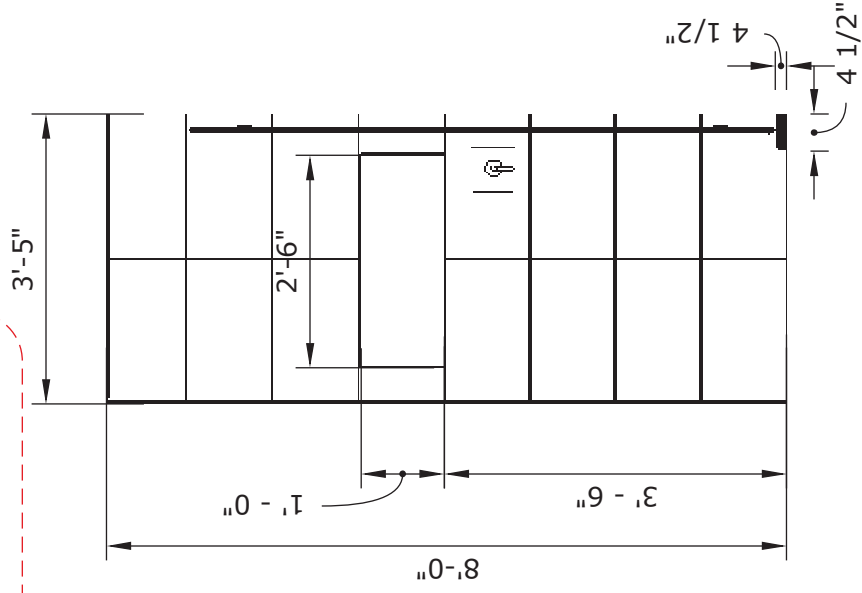

ISSUE
3/3/2023

RE-ISSUE
MM.DD.YY

DESCRIPTION
PRIMARY
BATHROOM

C BATHROOM 2 ELEVATION

B2

1.11

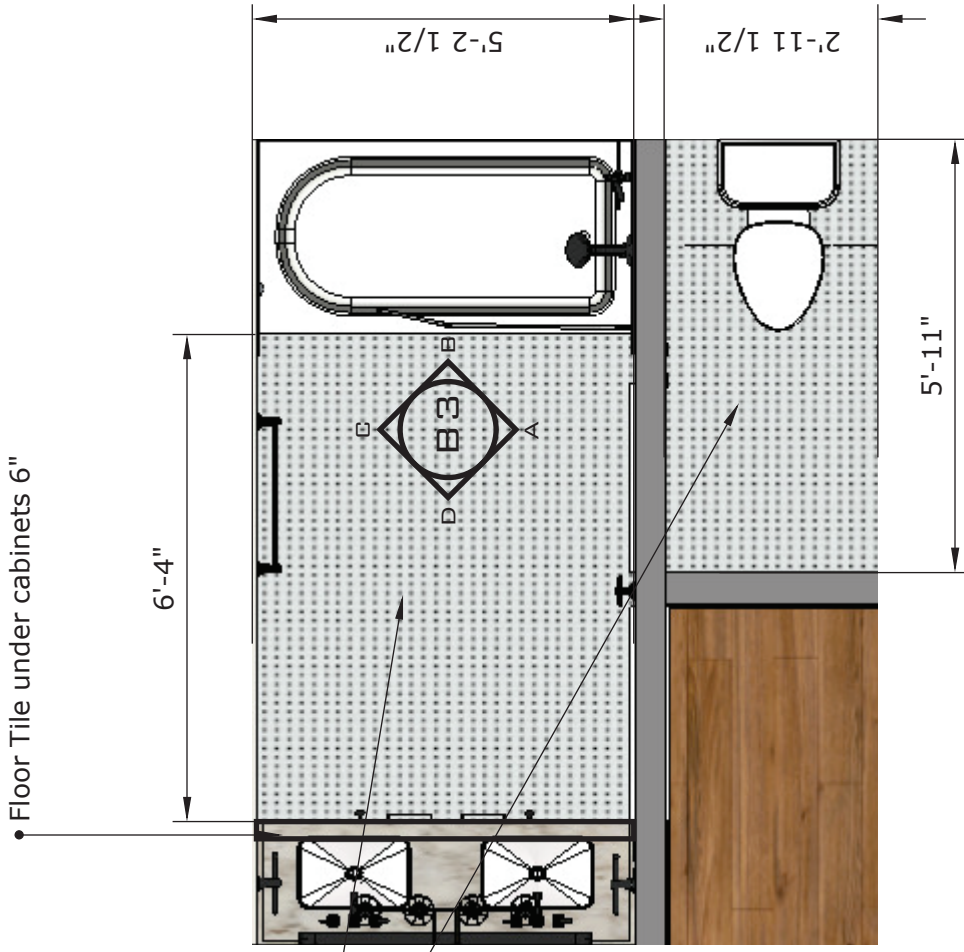

FLOOR TILE:
 BEDROSIANS
 ~62 SF
 LE CAFE BASKET WEAVE 1 X 2
 DIRECTION/ORIENTATION: N/A
 PATTERN: N/A
 GROUT: 1/8" JOINT (#640 ARCTIC WHITE)

ISSUE
 3/3/2023

RE-ISSUE
 MM.DD.YY

DESCRIPTION
 PRIMARY
 BATHROOM

1 BATHROOM 3 FLOOR PLAN

B3
1.12

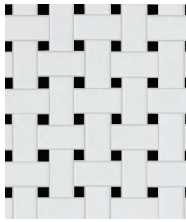

WALL TILE:

BEDROSIANS
~15 SF

LE CAFÉ 1" X 2" BASKET WEAVE

DIRECTION/ORIENTATION: MOSAIC SHEET

PATTERN: MOSAIC SHEET

GROUT: 1/8" JOINT (#640 ARCTIC WHITE)

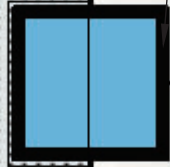
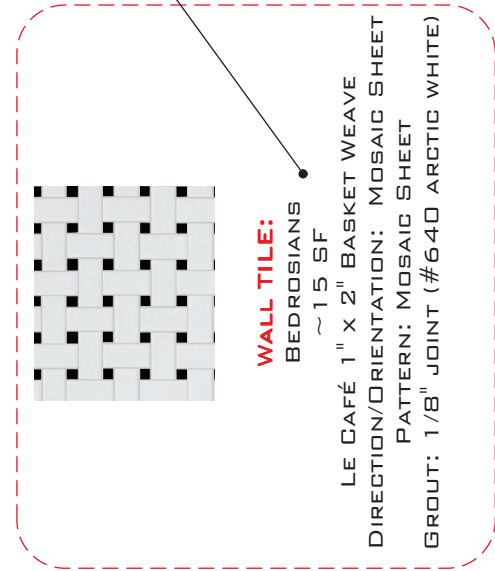

TRIM TILE:

BEDROSIANS
~12 PIECES

CLARA 1/2" PENCIL MATTE NOIR

DIRECTION/ORIENTATION: N/A

PATTERN: N/A

GROUT: N/A

*CENTER BORDER AT WINDOW

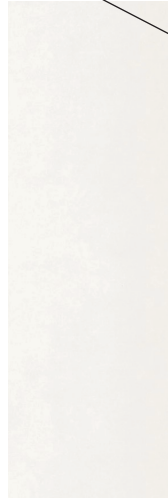
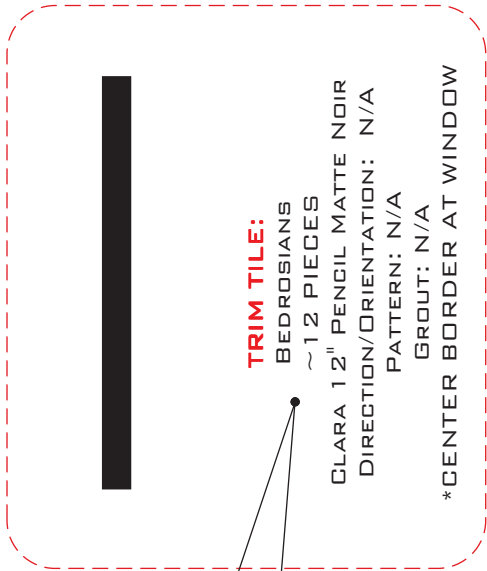

WALL TILE:

BEDROSIANS
~25 SF

DONNA 13 X 40

DIRECTION/ORIENTATION: HORIZONTAL

PATTERN: STACK

GROUT: 1/8" JOINT (#640 ARCTIC WHITE)

*CENTER GROUT JOINT ON WALL

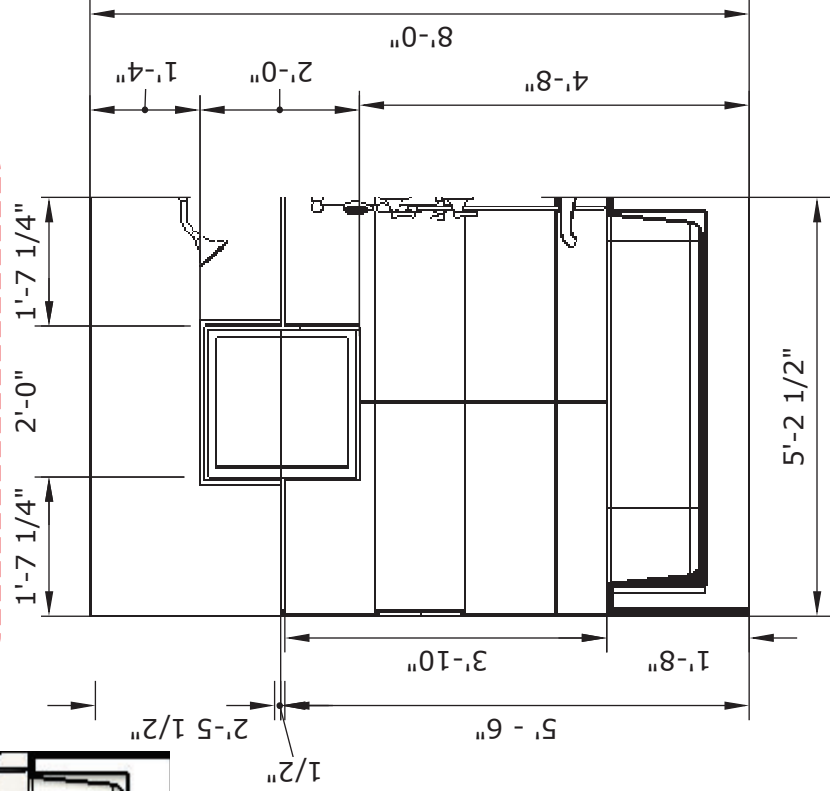
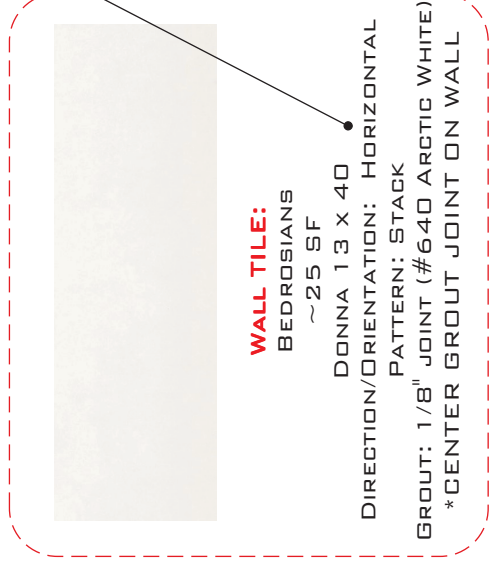

ISSUE
3/3/2023

RE-ISSUE
MM.DD.YY

DESCRIPTION
PRIMARY
BATHROOM

B

BATHROOM 3 ELEVATION

B3

1.13



WALL TILE:

BEDROSIANS
~8 SF
LE CAFÉ 1" X 2" BASKET WEAVE
DIRECTION/ORIENTATION: MOSAIC SHEET
PATTERN: MOSAIC SHEET
GROUT: 1/8" JOINT (#640 ARCTIC WHITE)

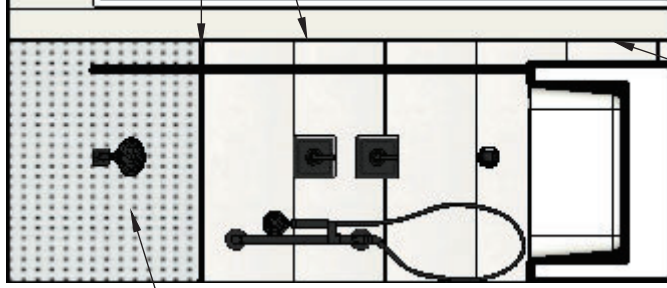

TRIM TILE:

BEDROSIANS
~12 PIECES
CLARA 12" PENCIL MATTE NOIR
DIRECTION/ORIENTATION: N/A
PATTERN: N/A
GROUT: N/A

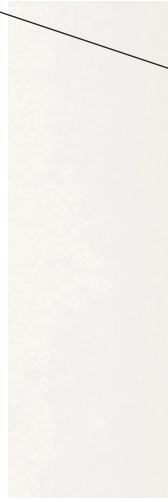

WALL TILE:

BEDROSIANS
~20 SF
DONNA 13 X 40
DIRECTION/ORIENTATION: HORIZONTAL
PATTERN: STACK
GROUT: 1/8" JOINT (#640 ARCTIC WHITE)

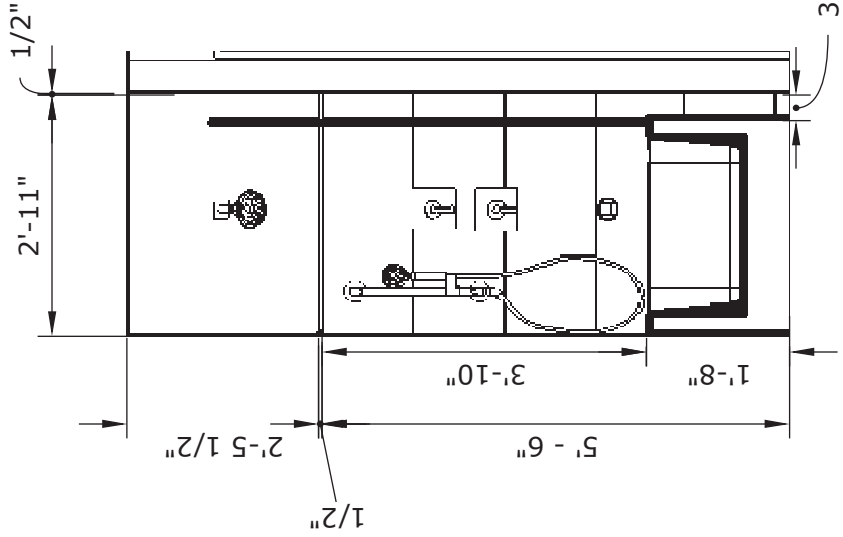

ISSUE
3/3/2023

RE-ISSUE
MM.DD.YY

DESCRIPTION
PRIMARY
BATHROOM

B3

1.14

A BATHROOM 3 ELEVATION

A

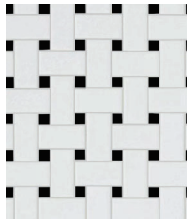

WALL TILE:
 BEDROSIANS
 ~10 SF
 LE CAFÉ 1" X 2" BASKET WEAVE
 DIRECTION/ORIENTATION: MOSAIC SHEET
 PATTERN: MOSAIC SHEET
 GROUT: 1/8" JOINT (#640 ARCTIC WHITE)

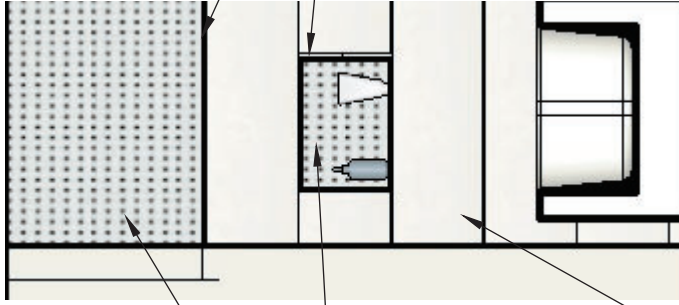

TRIM TILE:
 BEDROSIANS
 ~19 PIECES
 CLARA 12" PENCIL MATTE NOIR
 DIRECTION/ORIENTATION: N/A
 PATTERN: N/A
 GROUT: N/A

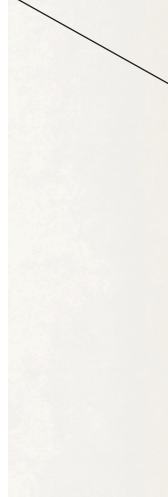

WALL TILE:
 BEDROSIANS
 ~18 SF
 DONNA 13 X 40
 DIRECTION/ORIENTATION: HORIZONTAL
 PATTERN: STACK
 GROUT: 1/8" JOINT (#640 ARCTIC WHITE)

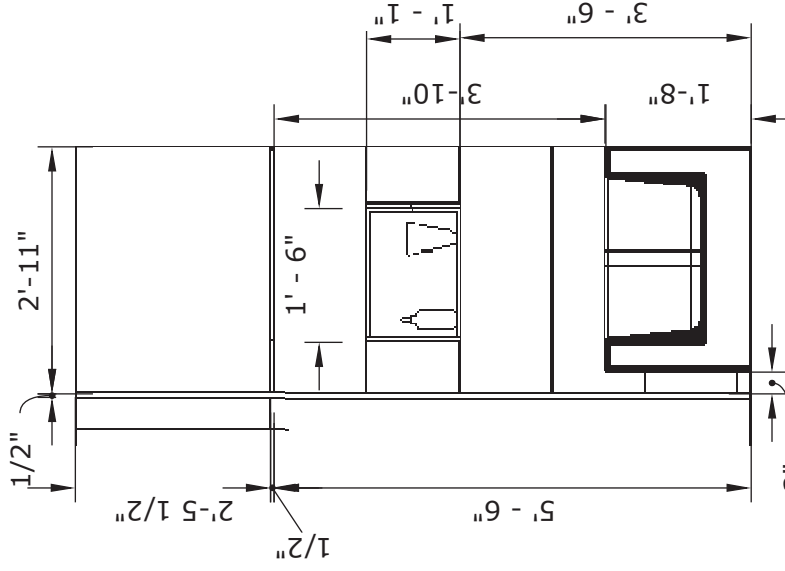

BATHROOM 3 ELEVATION

RE-ISSUE
 MM.DD.YY

DESCRIPTION
 PRIMARY
 BATHROOM

B3

1.15

RE-ISSUE
MM.DD.YY

DESCRIPTION
PRIMARY
BATHROOM

BP 1.16



FLOOR TILE:
~33 SF
BEDROSIANS
WAVE 12 X 24
DIRECTION/ORIENTATION: HORIZONTAL
PATTERN: 1/3 OFFSET
GROUT: 1/8" JOINT (#545 BLEACHED WOOD)



SHOWER FLOOR TILE:
~13 SF
BEDROSIANS
LE CAFE 1 X 1 HEXAGON MATTE
PORCELAIN TILE IN WHITE
DIRECTION/ORIENTATION: MOSAIC
PATTERN: MOSAIC
GROUT: 1/8" JOINT (#643 WARM GRAY)

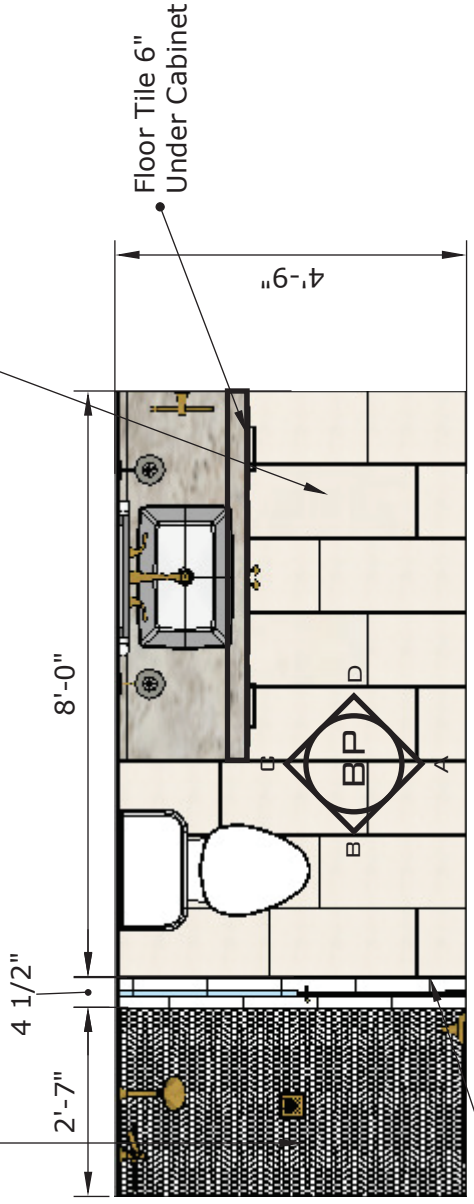

- *FACE CURB IN WALL TILE
 - * TRIM CURB ON BOTH SIDES WITH SCHLUTER JOLLY IN BRIGHT WHITE
- QTY: 2

1 POOL BATHROOM FLOOR PLAN

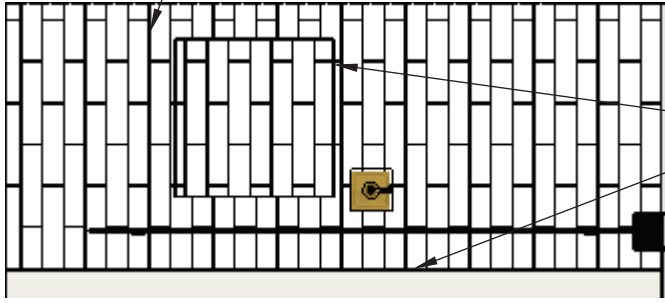

WALL TILE:
 ~25 SF
 BEDROSIANS
 TRADITIONS 3 X 12
 GLOSSY PORCELAIN TILE IN WHITE
 DIRECTION/ORIENTATION: HORIZONTAL
 PATTERN: 1/3 OFFSET
 GROUT: 1/8" JOINT (#643 WARM GRAY)



*TRIM OPEN END AND NICHE IN
 METAL SCHLUTER JOLLY
 IN BRIGHT WHITE
 QTY: 2

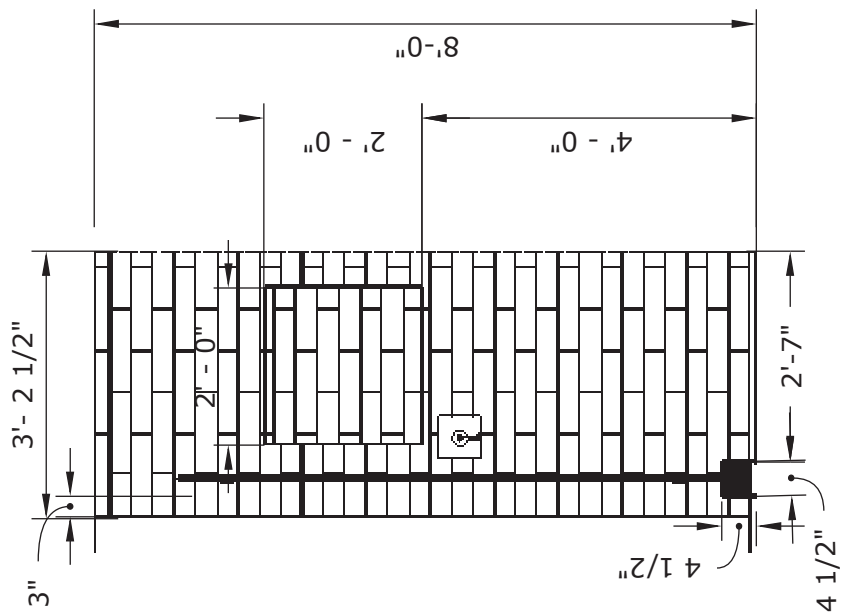

RE-ISSUE
 MM.DD.YY

DESCRIPTION
 PRIMARY
 BATHROOM

BP

1.17

A POOL BATHROOM ELEVATION



WALL TILE:

~40 SF

MONET MAGIC
MARINA BLOCKS

DIRECTION/ORIENTATION: MOSAIC SHEET

PATTERN: MOSAIC 12X12 SHEET

GROUT: 1/8" JOINT (#640 ARCTIC WHITE)

4'-9 1/2"

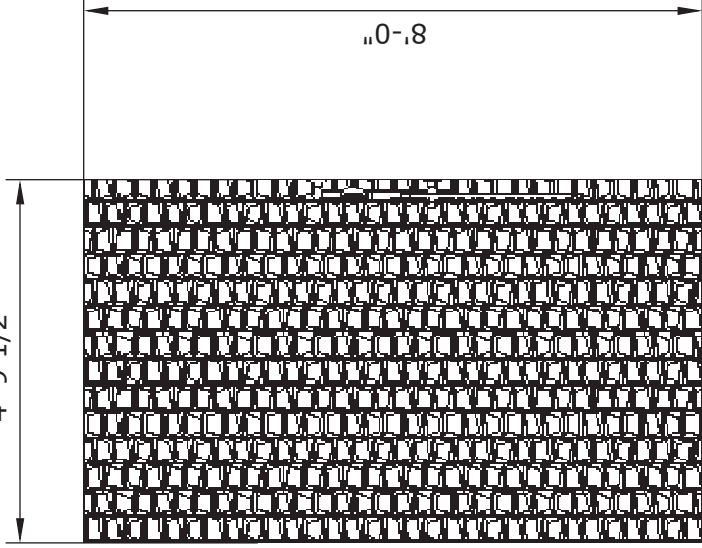

0'-8

RE-ISSUE
MM.DD.YY

DESCRIPTION
PRIMARY
BATHROOM

B POOL BATHROOM ELEVATION

BP
1.18

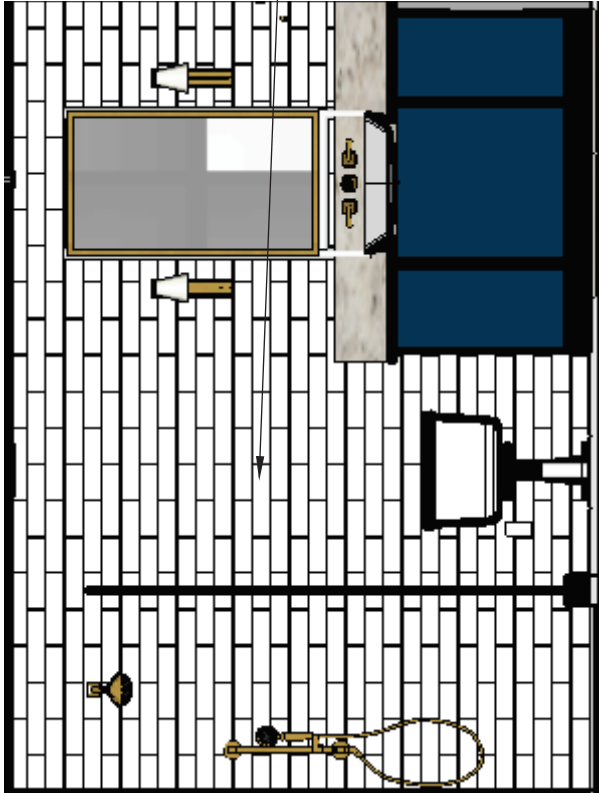

WALL TILE:
 ~25 SF
 BEDROSIANS
 TRADITIONS 3 X 12
 GLOSSY PORCELAIN TILE IN WHITE
 DIRECTION/ORIENTATION: HORIZONTAL
 PATTERN: 1/3 OFFSET
 GROUT: 1/8" JOINT (#643 WARM GRAY)

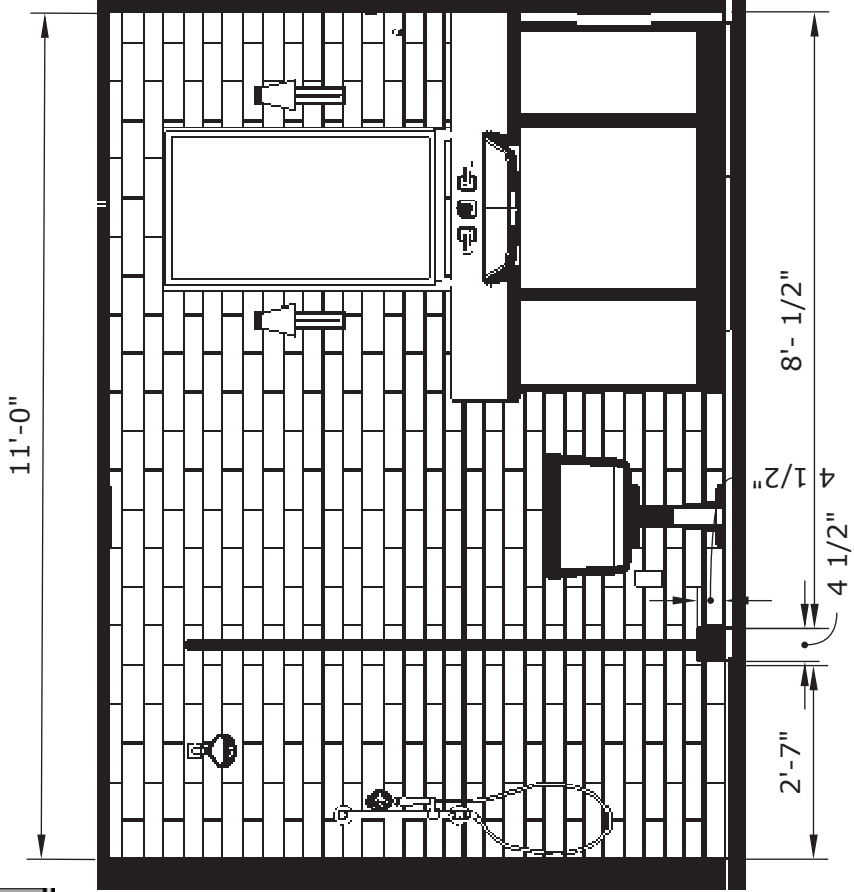

ISSUE
 3/3/2023

RE-ISSUE
 MM.DD.YY

DESCRIPTION
 PRIMARY
 BATHROOM

BP
1.19

C POOL BATHROOM ELEVATION



FLOOR TILE:

AZ TILE
~20SF
PAROS WHITE 12 X 12
DIRECTION/ORIENTATION: HORIZONTAL
PATTERN: STACK
GROUT: 1/8" JOINT (#60 CHARCOAL)



FLOOR TILE:

AZ TILE
~20SF
PAROS BLACK 12 X 12
DIRECTION/ORIENTATION: HORIZONTAL
PATTERN: STACK
GROUT: 1/8" JOINT (#60 CHARCOAL)

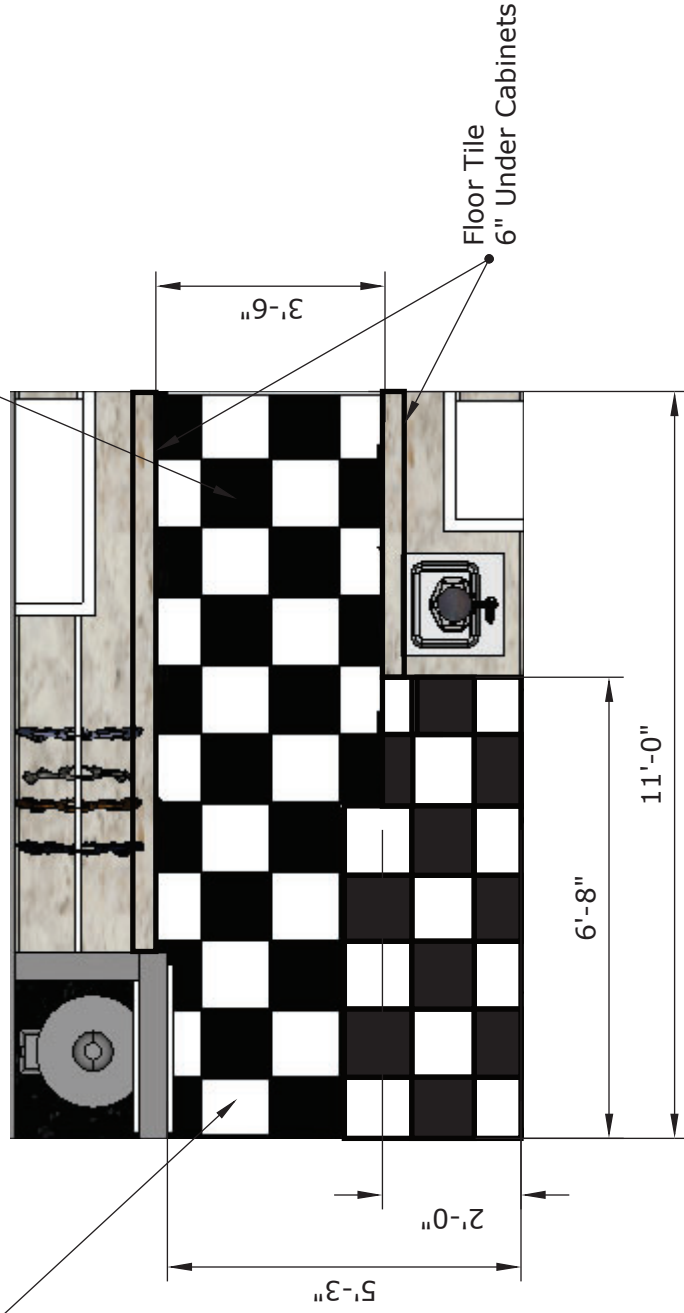

1 LAUNDRY ROOM FLOOR PLAN

RE-ISSUE
MM.DD.YY

DESCRIPTION
PRIMARY
BATHROOM

L
1.20

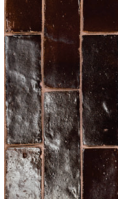

FLOOR TILE:
BEDROSIANS
~7 SF
ZEGORA SERIES 2 X 6
MAROON
DIRECTION/ORIENTATION: HORIZONTAL
PATTERN: 50% OFFSET
GROUT: 1/8" JOINT (#52 TOBACCO
BROWN)

6'-6"



1'-0"

1 ACCESSORY FIREPLACE FLOOR PLAN

RE-ISSUE
MM.DD.YY

DESCRIPTION
PRIMARY
BATHROOM

L

1.21



WALL TILE:

~19 SF

BEDROSIANS

ZAGORA SERIES 4X4

MAROON

DIRECTION/ORIENTATION: HORIZONTAL

PATTERN: STACK

GROUT: 1/8" JOINT (#52 TOBACCO

BROWN)

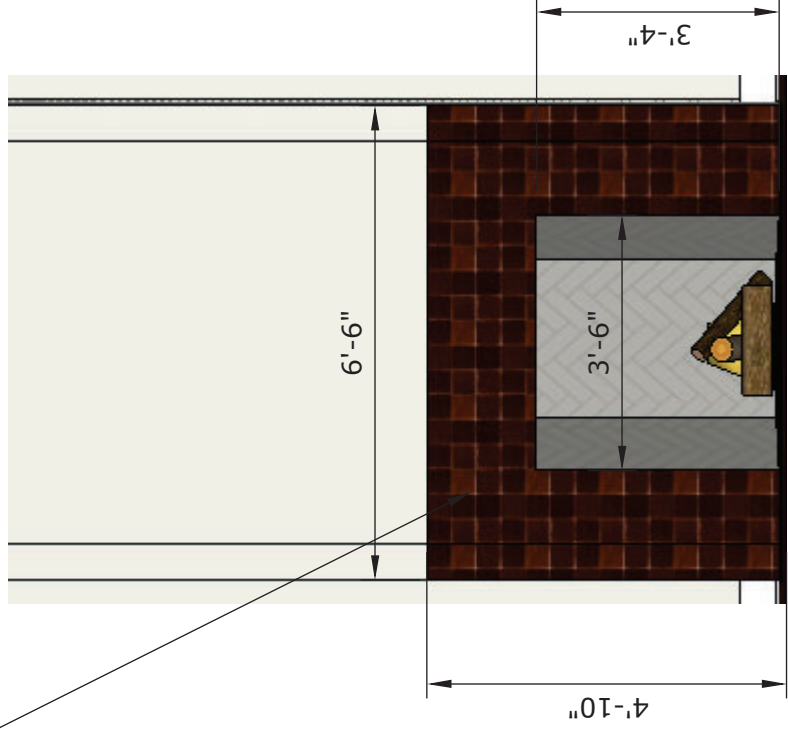

ACCESSORY FIREPLACE

A

RE-ISSUE
MM.DD.YY

DESCRIPTION
PRIMARY
BATHROOM

BP

1.22



FLOOR TILE:

~43 SF
AZTILE
UNICA CARBON 12 X 24
DIRECTION/ORIENTATION: HORIZONTAL
PATTERN: 1/3 OFFSET
GROUT: 1/8" JOINT (#TBD)

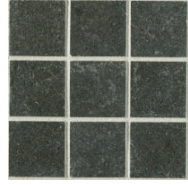

SHOWER FLOOR TILE:

~15 SF
AZTILE
UNICA CARBON 2X2
DIRECTION/ORIENTATION: STACK
PATTERN: STACK
GROUT: 1/8" JOINT (#TBD)

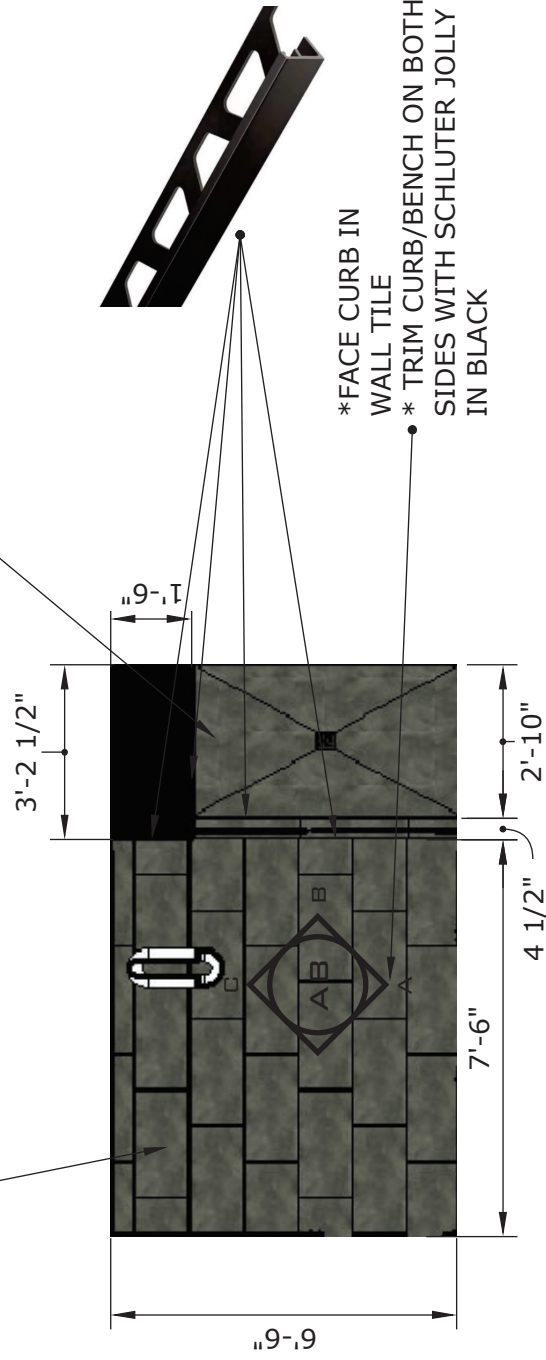

ISSUE
3/3/2023

RE-ISSUE
MM.DD.YY

DESCRIPTION
PRIMARY
BATHROOM

1 ACCESSORY BATHROOM FLOOR PLAN

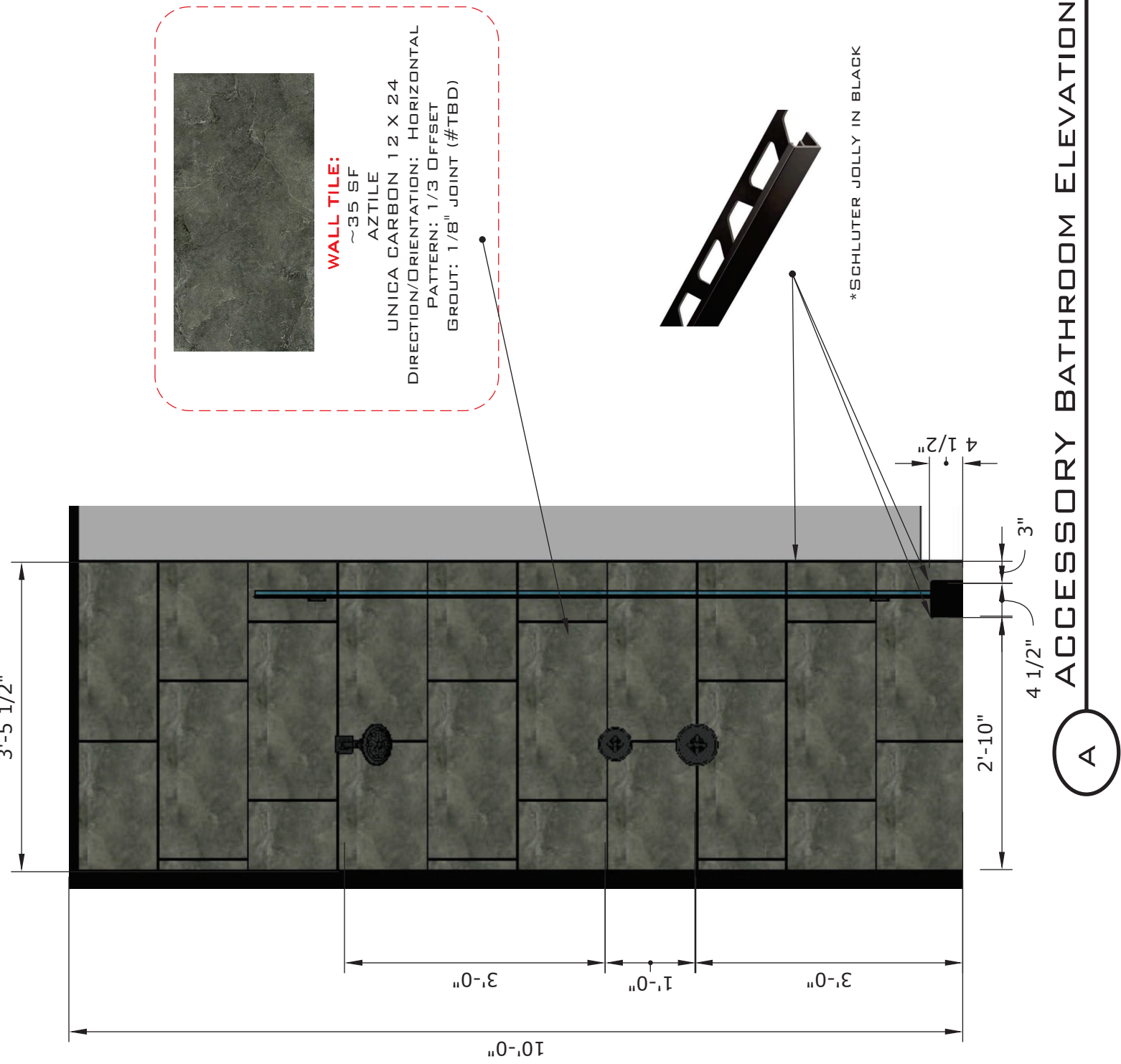

WALL TILE:
~35 SF
AZTILE

UNICA CARBON 12 X 24
DIRECTION/ORIENTATION: HORIZONTAL
PATTERN: 1/3 OFFSET
GROUT: 1/8" JOINT (#TBD)



*SCHLUTER JOLLY IN BLACK

ISSUE
3/3/2023

RE-ISSUE
MM.DD.YY

DESCRIPTION
PRIMARY
BATHROOM

BP

1.24

ACCESSORY BATHROOM ELEVATION



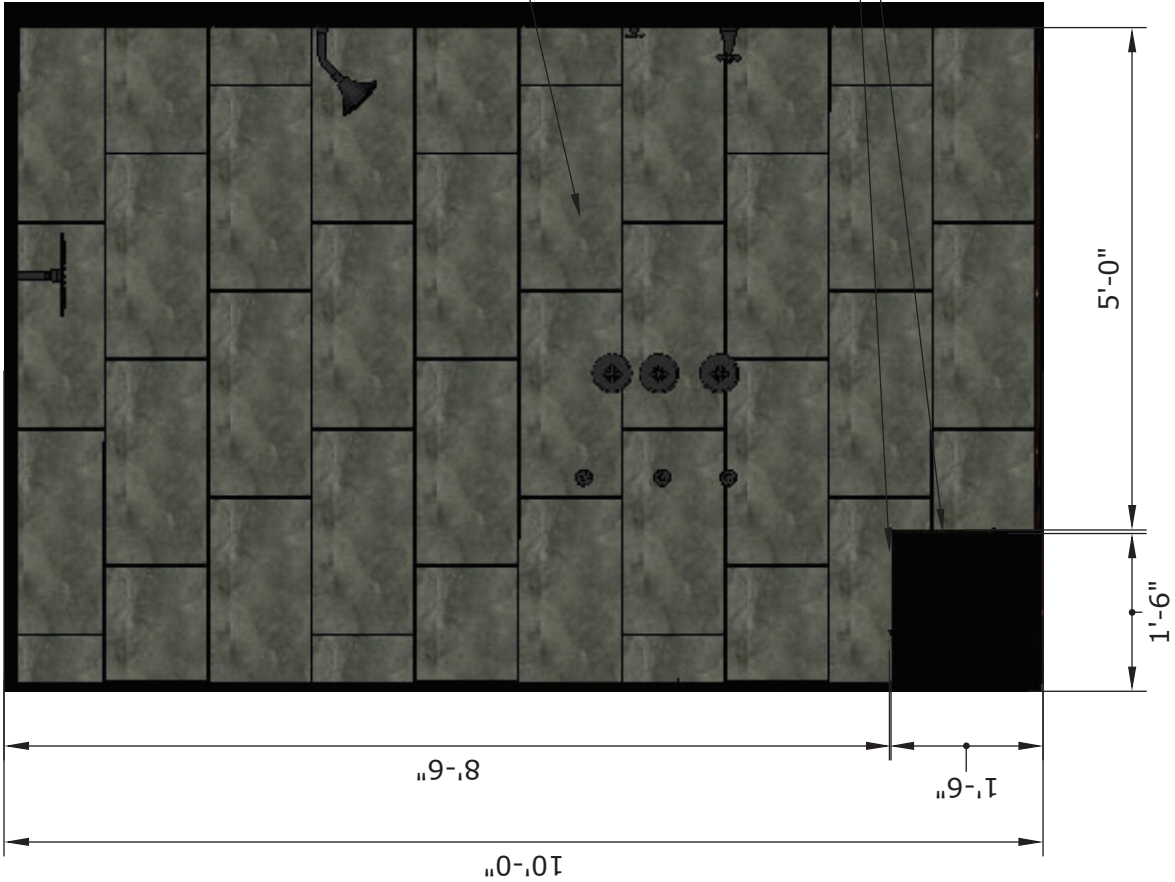

WALL TILE:
 ~66 SF
 AZTILE
 UNICA CARBON 12 X 24
 DIRECTION/ORIENTATION: HORIZONTAL
 PATTERN: 1/3 OFFSET
 GROUT: 1/8" JOINT (#TBD)



*SCHLUTER JOLLY IN BLACK

ISSUE
 3/3/2023

RE-ISSUE
 MM.DD.YY

DESCRIPTION
 PRIMARY
 BATHROOM

BP
1.25

B ACCESSORY BATHROOM ELEVATION

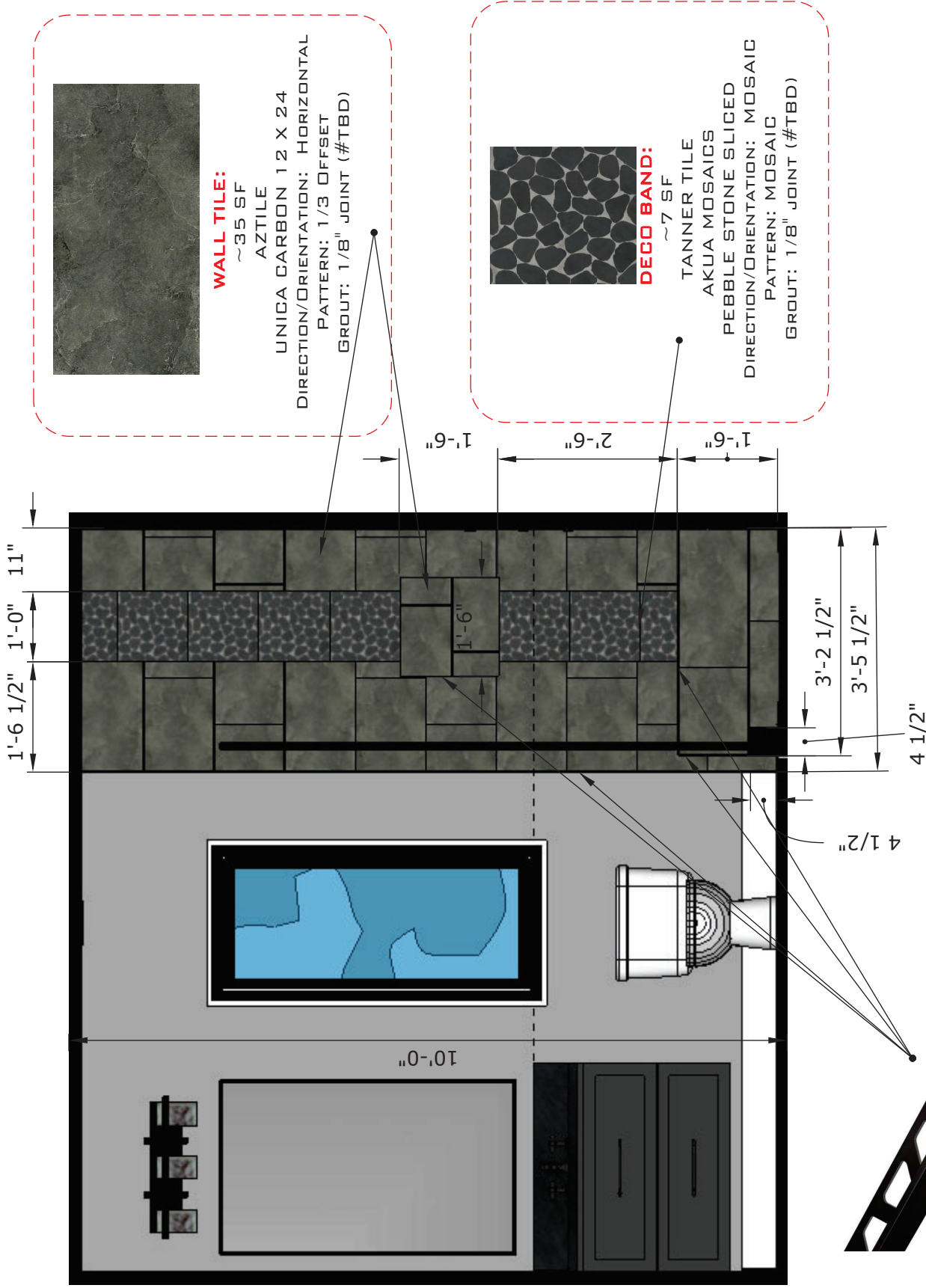

WALL TILE:
 ~35 SF
 AZTILE
 UNICA CARBON 12 X 24
 DIRECTION/ORIENTATION: HORIZONTAL
 PATTERN: 1/3 OFFSET
 GROUT: 1/8" JOINT (#TBD)

DECO BAND:
 ~7 SF
 TANNER TILE
 AKUA MOSAICS
 PEBBLE STONE SLICED
 DIRECTION/ORIENTATION: MOSAIC
 PATTERN: MOSAIC
 GROUT: 1/8" JOINT (#TBD)

RE-ISSUE
 MM.DD.YY

DESCRIPTION
 PRIMARY
 BATHROOM

BP
 1.26

ACCESSORY BATHROOM ELEVATION



*SCHLUTER JOLLY IN BLACK